

BD50F Direct Current Compressor R134a, 12-24V DC & 100-240V AC 50/60Hz



General

Code number (without electronic units)	101Z0203
Electronic unit - Standard	101N0210, 30 pcs: 101N0211
Electronic unit 12-24V DC - EMI (with metal shielding)	101N0220, 30 pcs: 101N0221
Electronic unit 12-24V DC - High Start Performance	101N0230, 30 pcs: 101N0231
Electronic unit 12-24V DC - AEO & EMI	101N0320, 30 pcs: 101N0321
Electronic unit 12-24V DC - AEO & EMI & High Start	101N0330, 30 pcs: 101N0331
Electronic unit 12-24V DC & 100-240V AC 50/60Hz	101N0500, 36 pcs: 101N0501
Approved compressor - electronic unit combinations	refer to <i>Instructions</i> for 101N0xxx
Additional approvals	e4, C-Tick
Compressors on pallet	150

Application

Application	LBP/MBP/HBP	
Evaporating temperature	°F	-20 to 50
Voltage range DC	VDC	9.6 - 17 / 21.3 - 31.5
Voltage range AC	V/Hz	100 - 240 / 50 - 60
Max. condensing temperature continuous (short)	°F	140 (158)
Max. winding temperature continuous (short)	°F	257 (275)

Cooling requirements

Application	LBP	MBP	HBP
32°C	S	S	F ₁
38°C	S	S	F ₁
43°C	S	S	F ₁

Remarks on application: Fan cooling F₁ depending on application and speed.

Motor

Motor type	variable speed
Resistance, all 3 windings (25°C)	Ω 1.8

Design

Displacement	cu.in.	0.15
Oil quantity (type)	fl.oz.	5.1 (polyolester)
Maximum refrigerant charge	oz.	10.5
Free gas volume in compressor	fl.oz.	29.6
Weight - Compressor/Electronic unit	lbs.	9.5 / 0.59 (Standard)

Standard battery protection settings (refer to 101N0xxx *Instructions* for optional settings)

Voltage	12V	24V
Cut out	VDC 10.4	22.8
Cut in	VDC 11.7	24.2

Dimensions

Height	inch	A	5.39
		B	5.32
		B1	5.04
		B2	2.87
Suction connector	location/I.D. inch angle	C	0.252-0.259 40°
	material comment		Cu-plated steel Al cap
Process connector	location/I.D. inch angle	D	0.252-0.259 45°
	material comment		Cu-plated steel Al cap
Discharge connector	location/I.D. inch angle	E	0.202-0.205 21°
	material comment		Cu-plated steel Al cap

Remarks: **inch connectors**

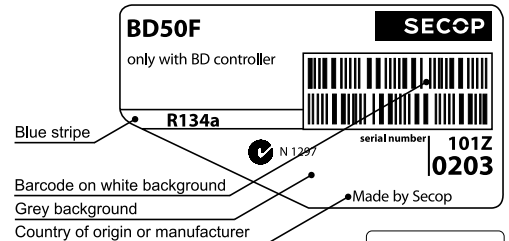

- S = Static cooling normally sufficient
- O = Oil cooling
- F₁ = Fan cooling 1.5 m/s (compressor compartment temperature equal to ambient temperature)
- F₂ = Fan cooling 3.0 m/s necessary
- SG = Suction gas cooling normally sufficient
- = not applicable in this area

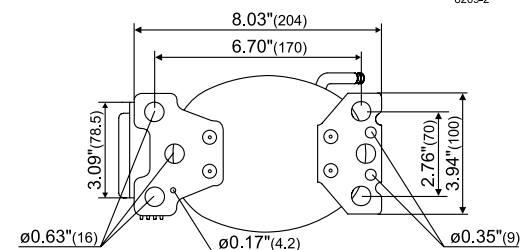
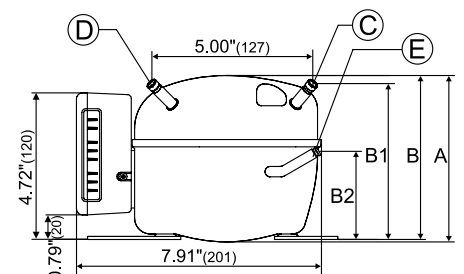
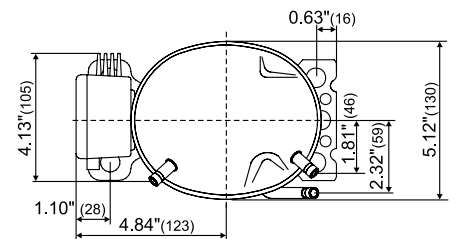

Capacity (ASHRAE LBP)			12V DC, static cooling								BTU/h	
rpm \ °F	-20	-13	-10	0	10	14	20	30	40	41	45	50
2,000	95	126	142	201	273	308	359	458	571	583	632*	697*
2,500	119	157	176	247	335	375	442	570	723*	740	809*	
3,000	142	189	211	297	402	450	529	682*	863*			
3,500	167	220	245	343	464	518*	612*	790*				

Capacity (EN 12900 Household/CECOMAF)			12V DC, static cooling								watt	
rpm \ °F	-20	-13	-10	0	10	14	20	30	40	41	45	50
2,000	22.6	30.0	33.6	47.7	64.9	72.6	85.2	109	135	138*	150*	165*
2,500	28.2	37.3	41.7	58.5	79.3	88.9	105	135	171*	175*	191*	
3,000	33.7	44.8	50.1	70.4	95.2	107	125	161*	204*			
3,500	39.8	52.2	58.2	81.3	110	123*	145*	187*				

Power consumption			12V DC, static cooling								watt	
rpm \ °F	-20	-13	-10	0	10	14	20	30	40	41	45	50
2,000	27.4	32.5	34.6	41.7	49.0	52.6	56.8	65.4	75.1	76.9*	80.4*	86.2*
2,500	34.3	41.4	44.3	54.0	63.4	67.7	73.0	82.8	93.1*	94.9*	98.6*	
3,000	41.4	50.1	53.7	65.2	76.2	81.3	87.4	98.9*	111*			
3,500	49.6	58.8	62.6	75.5	88.7	95.0*	103*	119*				

Current consumption (for 24V applications the following must be halved)												A
rpm \ °F	-20	-13	-10	0	10	14	20	30	40	41	45	50
2,000	2.28	2.69	2.87	3.50	4.18	4.49	4.90	5.65	6.45	6.58*	6.87*	7.29*
2,500	2.86	3.41	3.65	4.45	5.26	5.61	6.10	6.94	7.81*	7.94*	8.25*	
3,000	3.52	4.16	4.43	5.37	6.33	6.75	7.31	8.32	9.34*			
3,500	4.20	4.88	5.18	6.24	7.39	7.90*	8.61*	9.91*				

EER (ASHRAE LBP)			12V DC, static cooling								BTU/Wh	
rpm \ °F	-20	-13	-10	0	10	14	20	30	40	41	45	50
2,000	3.49	3.89	4.09	4.81	5.57	5.83	6.32	7.00	7.60	7.63*	7.86*	8.09*
2,500	3.47	3.81	3.97	4.58	5.28	5.52	6.05	6.89	7.76*	7.77*	8.21*	
3,000	3.43	3.77	3.93	4.55	5.27	5.52	6.05	6.89	7.76*			
3,500	3.37	3.74	3.91	4.54	5.23	5.46*	5.94*	6.66*				

COP (EN 12900 Household/CECOMAF)			12V DC, static cooling								W/W	
rpm \ °F	-20	-13	-10	0	10	14	20	30	40	41	45	50
2,000	0.82	0.92	0.96	1.13	1.31	1.38	1.48	1.64	1.78	1.79*	1.84*	1.90*
2,500	0.82	0.90	0.94	1.08	1.24	1.31	1.42	1.62	1.82	1.89*	1.93*	
3,000	0.81	0.89	0.93	1.07	1.24	1.31	1.42	1.62	1.82*			
3,500	0.80	0.88	0.92	1.07	1.23	1.30*	1.40*	1.56*				

power consumption is limited to 100W with 101N0500 * fan cooling of electronic unit compulsory

Test conditions	EN 12900/CECOMAF	ASHRAE LBP
Condensing temperature	131°F	130°F
Ambient temperature	90°F	90°F
Suction gas temperature	90°F	90°F
Liquid temperature	no subcooling	90°F

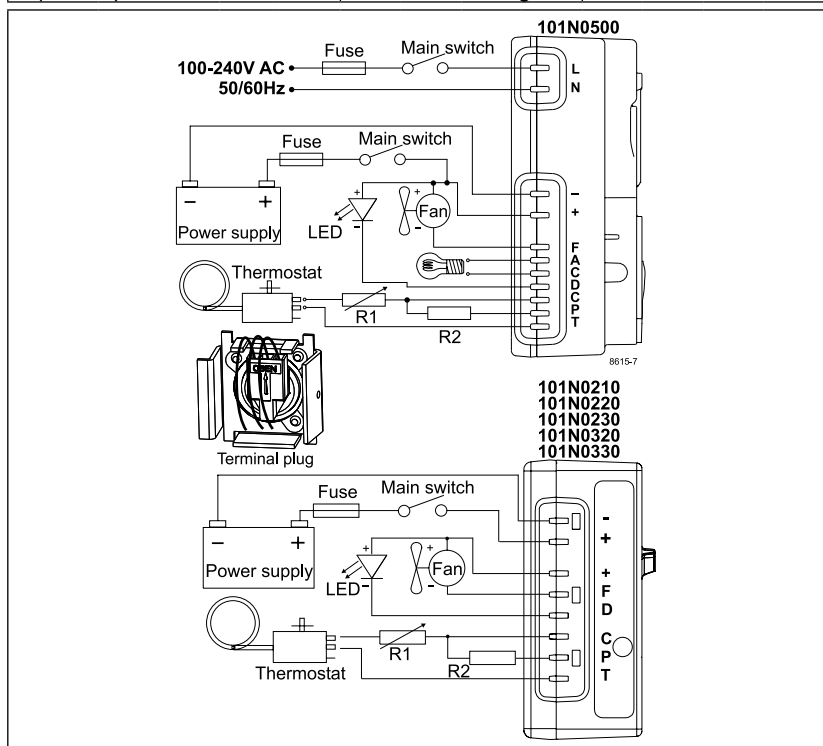

Operational errors shown by LED (optional)	
Error code	Error type
5	Thermal cut-out of electronic unit (If the refrigeration system has been too heavily loaded, or if the ambient temperature is high, the electronic unit will run too hot).
4	Minimum motor speed error (If the refrigeration system is too heavily loaded, the motor cannot maintain minimum speed at approximately 1,850 rpm).
3	Motor start error (The rotor is blocked or the differential pressure in the refrigeration system is too high (>5 bar)).
2	Fan over-current cut-out (The fan loads the electronic unit with more than 1A _{peak}).
1	Battery protection cut-out (The voltage is outside the cut-out setting).

Compressor speed

Electronit unit	Resistor (R1) [Ω] calculated values	Motor speed [rpm]	Control circuit current [mA]		
101N0210	0	2,000	5		
101N0220	277	2,500	4		
101N0230	692	3,000	3		
101N0500	1523	3,500	2		
			0	AEO	6
101N0320	173	2,000	5		
101N0330 with AEO	450	2,500	4		
			865	3,000	3
			1696	3,500	2

In AEO (Adaptive Energy Optimizing) speed mode the BD compressor will always adapt its speed to the actual cooling demand.

Wire Dimensions DC

Cross section [mm²]	Size AWG [Gauge]	Max. length* 12V operation		Max. length* 24V operation	
		[m]	[ft.]	[m]	[ft.]
2.5	12	2.5	8	5	16
4	12	4	13	8	26
6	10	6	20	12	39
10	8	10	33	20	66

*Length between battery an electronic unit

Wire Dimensions AC

Cross section min. 0.75 mm² or AWG 18

Accessories for BD50F	Code number
Bolt joint for one comp.	Ø: 5/8 in. 118-1917
Bolt joint in quantities	Ø: 5/8 in. 118-1918
Snap-on in quantities	Ø: 5/8 in. 118-1919
Remote kit (without cable)	105N9210

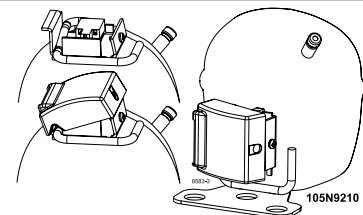

AC line cord UL approved	105N9520	
AC line cord VDE approved	105N9530	
DC usage:	Automobile fuse 12V: 15A DIN 7258 24V: 7.5 A Main switch min. 20A	Not deliverable from Secop
AC usage:	Fuse, 100-240V min. 4A Main switch min. 6A	

Danfoss can accept no responsibility for possible errors in catalogues, brochures and other printed material. Danfoss reserves the right to alter its products without notice. This also applies to products already on order provided that such alterations can be made without subsequent changes being necessary in specifications already agreed. All trademarks in this material are property of the respective companies. Danfoss and the Danfoss logotype are trademarks of Danfoss A/S. All rights reserved.